

**STRAIGHT PLUG CLAMP TYPE
CABLE LCF 7/8**

R185.033.000
SERIES 7-16

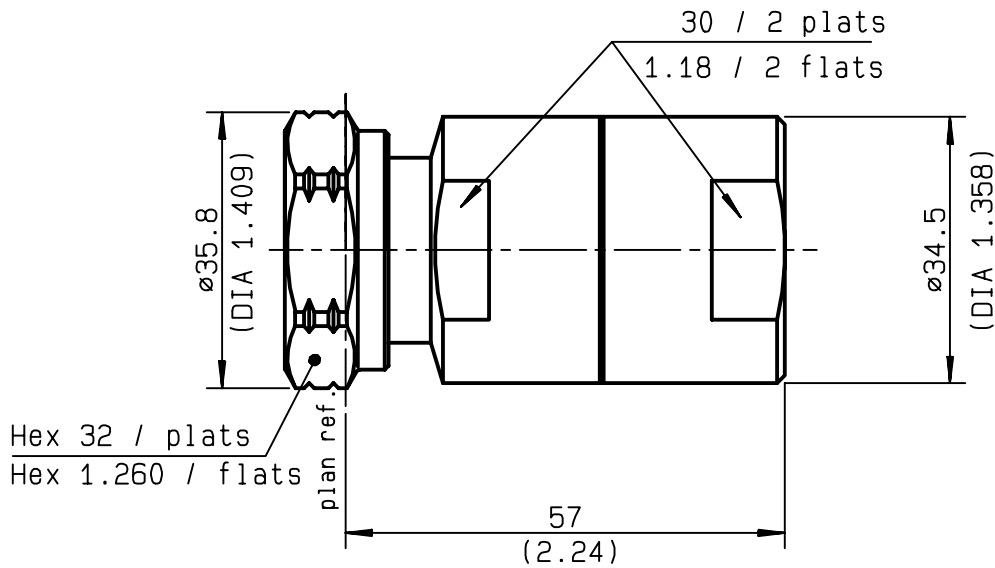

NOMINAL IMPEDANCE	50 Ω	CABLES : LCF 7/8' Cu2Y
FREQUENCY RANGE	0-7.5 GHz	
TEMPERATURE RATING	-55/+155 °C	
V.S.W.R	1.10 + x F(GHz)Maxi	
RF INSERTION LOSS	0.05 √F(GHz) dB Maxi	
VOLTAGE RATING	1400 Veff Maxi	
DIELECTRIC WITHSTANDING VOLTAGE	2700 Veff Mini	
INSULATION RESISTANCE	10000 MΩMini	
HERMETIC SEAL	NA Atm.cm ³ /s	
LEAKAGE (pressurized only)	NA	
MECHANICAL DURABILITY	500 Cycles	OTHERS CHARACTERISTICS
WEIGHT	192.3 gr	CABLE RETENTION 500 N Mini
SPECIFICATION		CENTER CONTACT RETENTION
		Axial force - mating end 200 N Mini
		Axial force - opposite end 200 N Mini
		Torque NA cm.N Mini
		RECOMMENDED TORQUES
		Mating 3000 cm.N
		Panel nut NA cm.N
		Clamp nut 2500 cm.N

CONNECTOR PARTS	MATERIALS	FINISH	(all values are given in micrometers)
BODY	BRASS	SILVER .	
OUTER CONTACT	BRASS	SILVER .	
CENTER CONTACT	BERYLLIUM COPPER	SILVER .	
INSULATOR	PTFE	-	
GASKET		-	
OTHERS PIECES	BRASS	NICKEL .	

ISSUE 9944D00	CREATION DATE 26/10/1995	FILE PART-NUMBER 94-1200-018
-------------------------	------------------------------------	--



FANJAT 0.

The information given here is subject to change without notice.
Design changes may be in order to improve the product .

Connect to the future



R185.033.000

ISSUE **9944D00** SERIES **7-16**

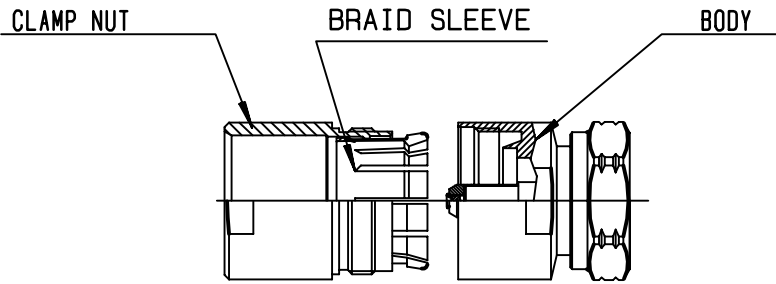

①

Disassembly of connector
Strip the cable
Position of cutting on corrugation crest.
Deburn (remove all the particles)
Do not deform the cable

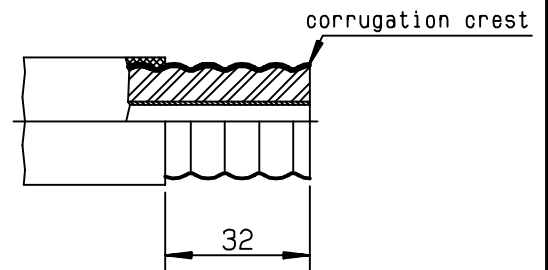

②

Slide the clamp nut and the braid sleeve onto cable until part snaps in at first corrugation root.

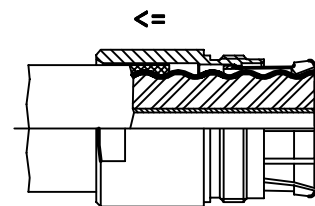

③

Slide the clamp nut over the braid sleeve until stop.

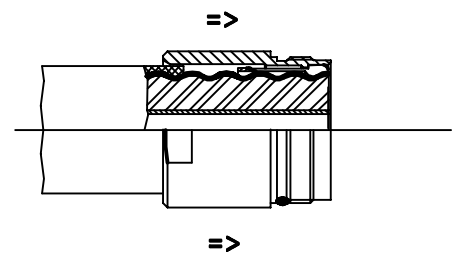

④

Slide the body.
Screw the clamp nut only.
(recommended coupling torque:25 Nm)

